



CANBERRA CONTRACTORS
CIVIL ENGINEERING CONTRACTORS

10 March 2022

Dear Neighbour/Tenant

WORKS UPDATE
EASTY ST TEMPORARY ROAD CLOSURE

This notice is an update to the information provided to you in February 2022.

Easty Street temporary road closure
Extended to late March / early April 2022

Canberra Contractors are working on behalf of Major Projects Canberra to improve pedestrian safety and signalise intersections along Launceston Street in preparation for the new CIT Woden Campus and the new Woden Public Transport Interchange works.

Easty Street will be open to through traffic by early April 2022. The team is working to have the road open as soon as possible given COVID impacts on staff, delays in receiving materials and any further rain / weather delays.

Canberra Contractors are currently working with Major Projects Canberra to allow works to progress in accordance with all COVID health guidelines to ensure safety for all our community members.

Please see access maps as shown overleaf. Please follow temporary road signs, and direction from traffic controller, we thank you for your patience and understanding while we undertake this important work. More project information is available at www.act.gov.au/citcampuswoden

Once Easty Street re-opens it will be to traffic in both directions. The construction of the Easty Street bus layover will continue behind safety fencing. Our team is also working to establish a new pedestrian crossing on Easty Street (near Childcare) along with new traffic signals and improved pedestrian safety on Launceston / Easty corner.

If you have any questions or would like to know more about the works, please call 6130 0524 to contact a Site Representative from Canberra Contractors or email us at mail@canberracontractors.com.au

Yours sincerely,

Daniel Hill
Project Manager
Canberra Contractors
(02) 6242 8122

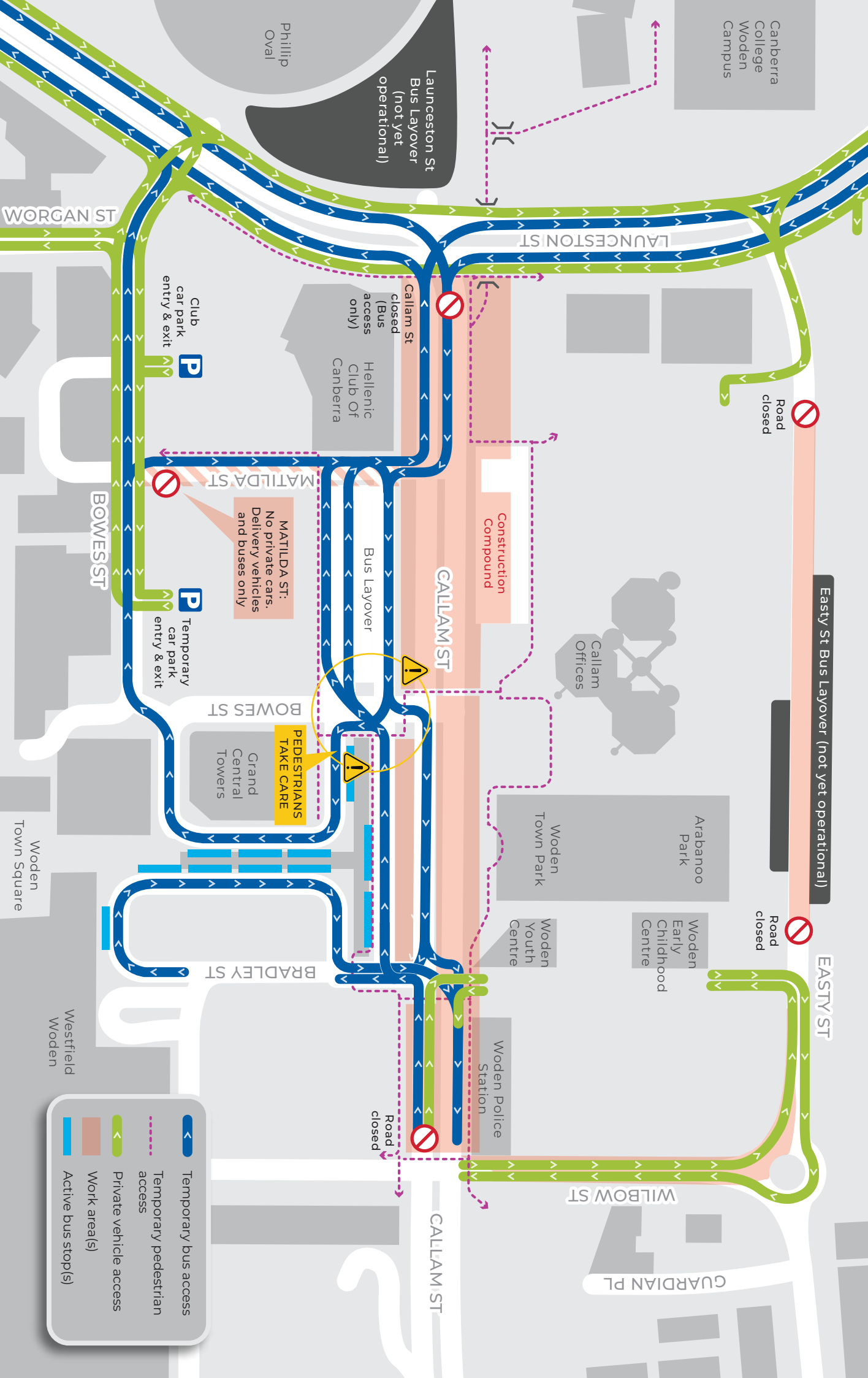

Canberra College
Woden Campus

Launceston St
Bus Layover
(not yet operational)

WORGAN ST

LAUNCESTON ST

Club car park
entry & exit

Callam St
closed
(Bus access only)

Hellenic Club Of Canberra

Road closed

MATILDA ST

MATILDA ST:
No private cars.
Delivery vehicles
and buses only

Construction Compound

Bus Layover

CALLAM ST

Callam Offices

BOWSES ST

Temporary car park
entry & exit

BOWSES ST

PEDESTRIANS TAKE CARE

Grand Central Towers

Woden Town Park

Arabanoo Park

Road closed

Woden Early Childhood Centre

Woden Youth Centre

EASTY ST

BRADLEY ST

Woden Police Station

Road closed

WILBOW ST

GUARDIAN PL

CALLAM ST

-  Temporary bus access
-  Temporary pedestrian access
-  Private vehicle access
-  Work area(s)
-  Active bus stop(s)
-  Temporary bus access
-  Temporary pedestrian access
-  Private vehicle access
-  Work area(s)
-  Active bus stop(s)

Westfield Woden

Woden Town Square

Phillip Oval