

# Light Rail to Woden Construction Update

Monthly Look Ahead for April 2023



**BUILT  
FOR  
CBR**



The ACT Government is building light rail to Woden to help make Canberra a more connected, sustainable, and vibrant city. This construction look ahead provides a summary of expected activity in the work zones for the month ahead on Raising London Circuit – an enabling project for light rail to Woden.

## Main works on Raising London Circuit

### Activities in April

- > Ongoing site preparation such as decommissioning streetlights, and vegetation, footpath and kerb removal
- > Erosion and sediment controls
- > Site remediation activities around London Circuit
- > Relocation of water, stormwater pipes and structures, wastewater mains and communications services
- > Potholing to identify existing service locations, and removing redundant services



## Sidetrack and bridge demolition

In the coming months, we will begin earthworks to build the sidetrack, including importing and stockpiling fill. The sidetrack will be built along the western side of the existing Commonwealth Avenue Bridge (northbound), and will ensure two lanes of traffic in both directions (northbound and southbound) are maintained during construction.

To build the sidetrack 10,000m<sup>3</sup> of fill will be brought in, which is equivalent to four Olympic swimming pools. Fill will be brought in stages via the site entrances at the intersection of Constitution Avenue and London Circuit and the intersection of Edinburgh Avenue and London Circuit and will be unloaded where the sidetrack will be

built. Towards the end of April, there will be some localised demolition of retaining walls on the west side of Commonwealth Avenue to prepare for sidetrack tie-in works. There may also be initial works on the existing southbound bridge.

### What is 'fill'?

Fill is material primarily consisting of soil that will be used to build up the sidetrack before asphalt and concrete are added. The fill will be collected from other sites undertaking off-site excavation and reused on our site. Before being brought onto the site it is rigorously tested for contaminated materials and to ensure it meets the engineering requirements.



## Site works April

Whilst these works are occurring there will be traffic changes and pedestrian and traffic management in place to ensure safety.

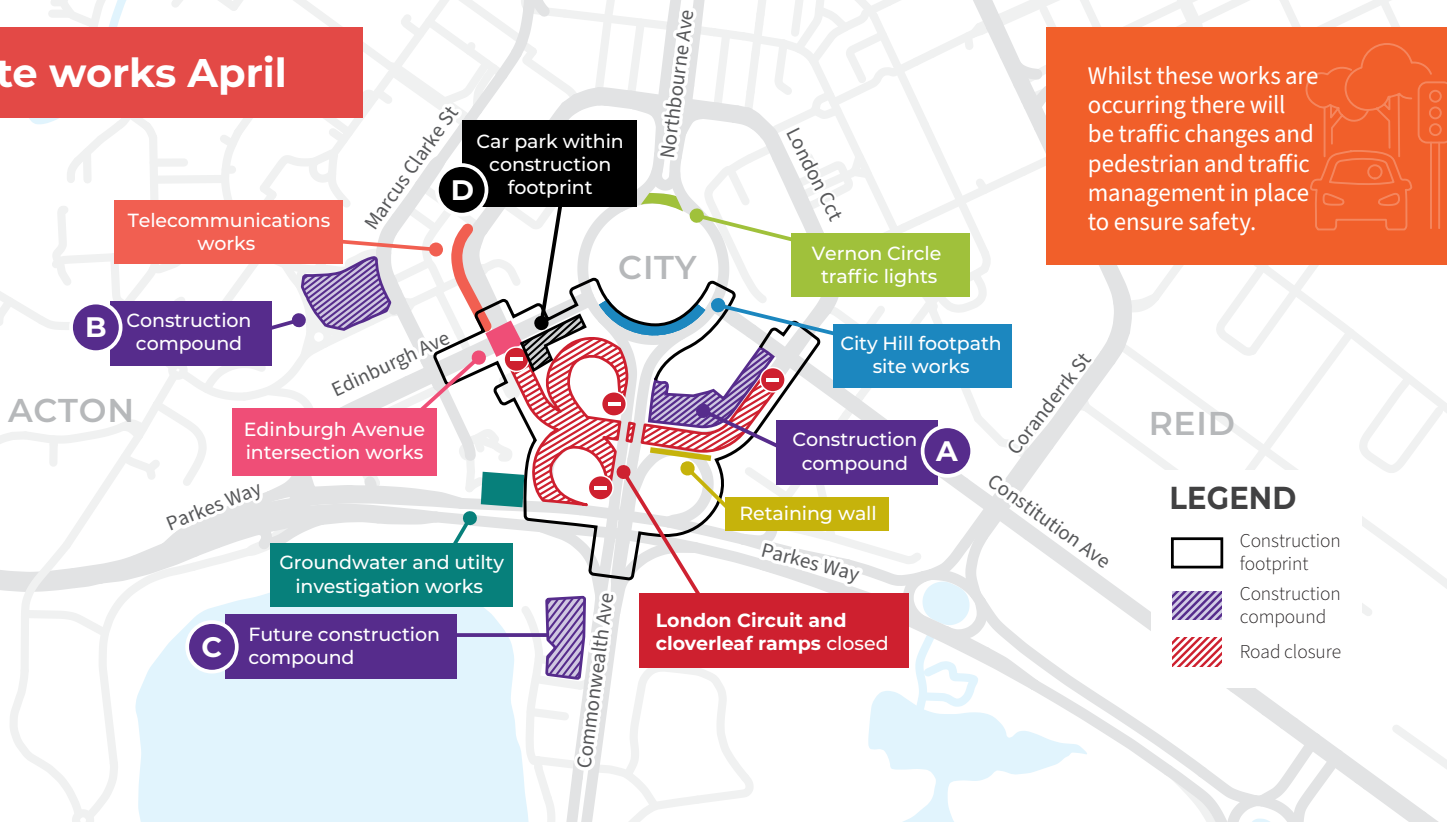

## Overall project works in April

### Early works – groundwater and utility investigations

Groundwater investigations to determine if there is suitable water yield for irrigating light rail's landscaping features will commence Monday 3 April and continue for the following 4-5 weeks along Parkes Way, west of Commonwealth Avenue Bridge.

Works will take place during standard weekday work hours (9:30am-4pm) and speed limits will be reduced in the area. Short rolling lane closures will be required on Parkes Way eastbound between Edinburgh Avenue and Commonwealth Avenue outside peak hours to allow vehicles and machinery to arrive or leave the work site. At completion of the borehole works all surface reinstatement within the grassed areas will be completed. Please be mindful of the work if driving in the area, follow all signage and maintain the reduced speed limit requirements.

Borehole re-drilling operations will be carried out using a truck mounted drill rig to investigate the ground conditions for a suitable potable and non-potable water supply.

### City Hill footpath

Some final work will be completed in April on the City Hill footpath, including landscaping and demobilisation of the work site. No road lane or footpath closures will be required.

### Early works – telecommunications work

Work will continue to connect new and existing infrastructure as well as reinstate the area following telecommunications trenching and conduit installation along London Circuit.

**PLEASE NOTE:**  
Service providers undertaking connections will issue a notification to customers if there are any scheduled impacts to existing services.

### Vernon Circle

In April, final reinstatement work including traffic signal adjustments and landscaping will be completed on Vernon Circle before the area is demobilised. Some of this work will be required to take place at night and involve lane or road closures.

### Edinburgh Avenue and London Circuit intersection

Work to modify the intersection of Edinburgh Avenue and London Circuit is required as part of the London Circuit closure. Throughout April, there will be traffic changes and lane closures at the Edinburgh intersection and along Edinburgh Avenue, between London Circuit and Marcus Clarke Street. Work

will be conducted for utility investigations and installation, along with the removal of the western traffic median (in front of the Metropolitan Building). Where traffic changes are required, traffic and pedestrian detours may be implemented. Local and pedestrian access, including access to the QT Hotel will always be maintained.

### New compound established

The carpark at site C on the Acton Waterfront is expected to temporarily close mid to late April to establish an additional construction site compound. Signage will be displayed onsite with more information. The raising London Circuit project is also using space at sites A, B and D on the map for site compounds.

### Parkes Way South-East off-ramp

In April, we will continue stormwater works on the Parkes Way off-ramp and commence construction of a retaining wall in this area. The retaining wall will be constructed by excavating the area, then forming and pouring the foundations. To safely carry out this work, safety barriers will be in place to protect work crews and motorists and reduced speed limits will be in place. Works in this area requiring lane closures will be completed at night to limit traffic impacts. Stormwater work in this area will be completed at night to limit traffic impacts.

## LEGEND

 Work area - road closed

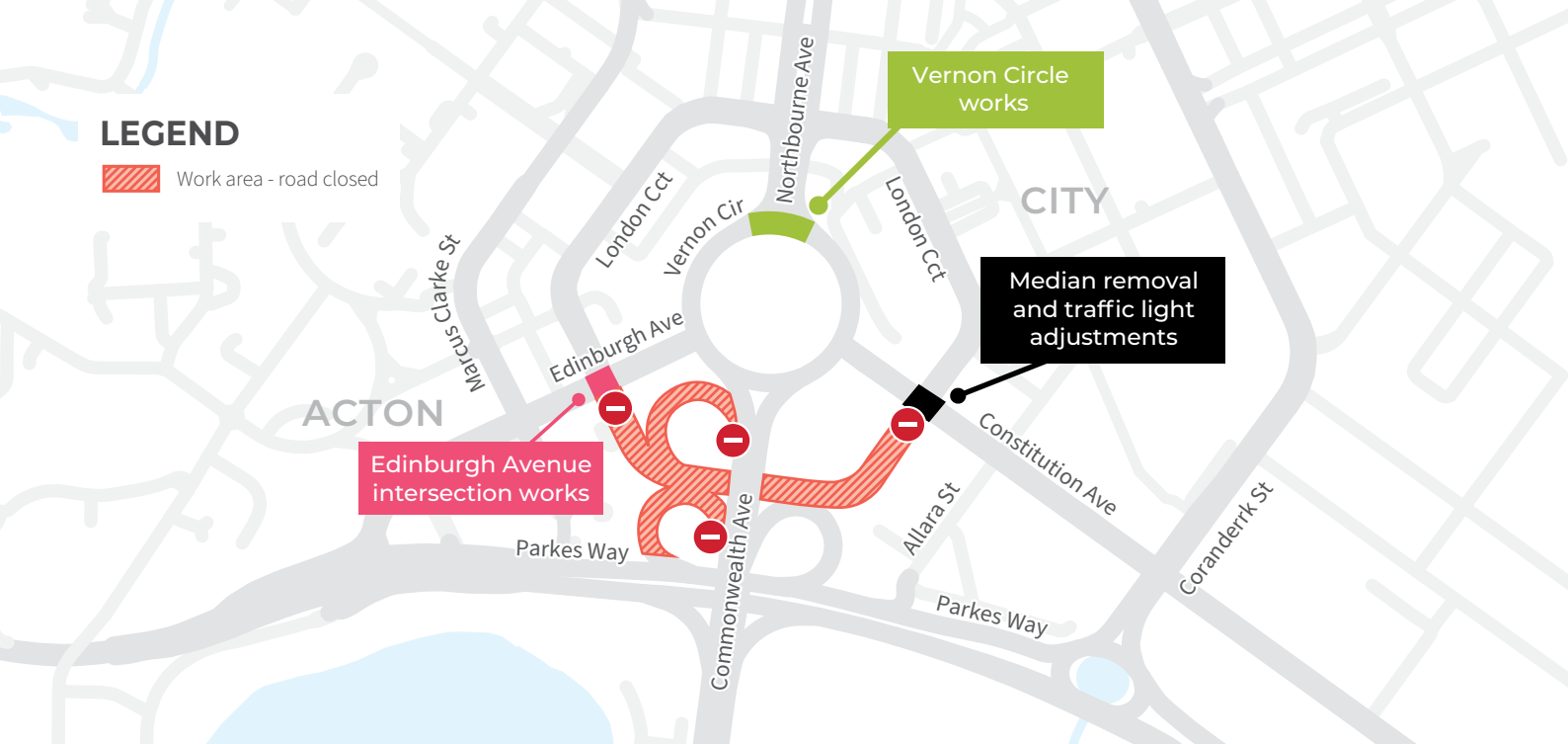

## Weekend day and night work

In April night work will be required at the intersection of Edinburgh Avenue and London Circuit to undertake utility cutovers. This work will be carried out by the asset owner and may include some noisy activities. Properties will be notified directly where services will be impacted. While work is undertaken there will be lane closures and traffic control in place around the intersection, but local access will be maintained.

The median at the intersection of Constitution Avenue and London Circuit needs to be removed to allow construction vehicles to enter and exit the site. This will be completed between **8pm and 6am from Tuesday 4 April to Thursday 6 April, and Tuesday 11 April to Friday 14 April**. Lane closures

and pedestrian diversions will be in place while this work is completed. Following the median removal, the traffic lights at this intersection will be adjusted to ensure traffic impacts from truck movements entering and exiting the site are minimised. This work will be completed between **8pm and 6am from Tuesday 11 April to Friday 14 April**. Traffic lights at this intersection will be turned off and traffic control will be in place while the changes are made.

Asphalt reinstatement works will be undertaken at Vernon Circle between **6am and 6pm Saturday 15 April and Sunday 16 April**. The work will involve lane closures on Vernon Circle (northbound and southbound). If delayed due to weather, works will be undertaken the following weekend.

Throughout April, low noise activities will take place between 6pm and 8pm and 6am and 7am. Activities will include moving materials, inspecting machinery, conducting pre-start meetings, cleaning work areas, removing temporary fencing and placing bollards.

Some oversized deliveries are required to be made at night due to road restrictions. These oversized trucks will come into the closure area or compound and will be unloaded before the truck leaves.

Other night works may need to take place in April. We will publish notifications on [act.gov.au/lightrailtowoden](http://act.gov.au/lightrailtowoden) to let you know when these works will take place.

## What to expect

While we make every effort to minimise construction disruption and impacts to the community, at times within the construction footprint area you can expect to experience higher levels of noise and dust, traffic, pedestrian and cyclist changes involving detours and an increase in construction vehicle movements. Throughout construction we will continue to notify of upcoming work and we will monitor our activities and make adjustments to our controls where needed.

Thank you for your patience and understanding while we carry out this important work.

To find out more about the project, visit [act.gov.au/lightrailtowoden](http://act.gov.au/lightrailtowoden)

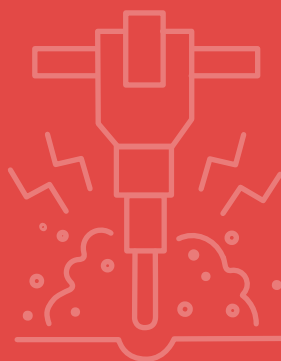

## Main works - work hours

Our standard construction work hours are **Monday to Friday 7am to 6pm and on Saturdays between 7am and 1pm**.

At times, to ensure safety and minimise impacts on the community, works will take place at night.

Dates, times and more information are notified in construction look aheads, by email, or online.

While we make every effort to inform you of upcoming construction activities, works are weather dependant and subject to change. Visit [act.gov.au/lightrailtowoden](http://act.gov.au/lightrailtowoden) to stay up to date.





## Asbestos management

As the Raising London Circuit project continues in April, construction activities such as excavation, removal of existing structures and utility work may result in the discovery of Asbestos Containing Material (ACM). Any ACM discovered will be analysed and removed by a licensed asbestos removalist. For more information about the removal of ACM, please refer to the project fact sheet on the **Light Rail to Woden website**.

## Sign up for updates

Use this **QR code** to sign up and receive this look ahead and supplementary construction notifications direct to your inbox.

Travel impacts will be published at **Travel impacts - Built for CBR**.



## Have your say

As part of the planning approval process for Light Rail Stage 2A City to Commonwealth Park, a Works Approval has been submitted to the National Capital Authority (NCA) and a Development Application has been submitted to the ACT Planning and Land Authority (ACTPLA).

To have your say on Light Rail Stage 2A, you can make a submission to the NCA or ACTPLA.

Visit [act.gov.au/lightrailtowoden](http://act.gov.au/lightrailtowoden) to learn more about the project and how to have your say.

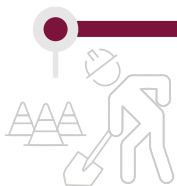

Early utility relocation works

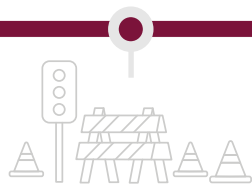

Signalisation and roadworks

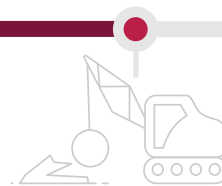

Main construction works start

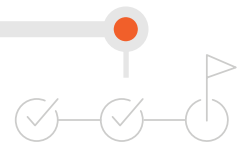

Raising London Circuit works completed



To speak to someone in a language other than English telephone the Telephone Interpreter Service (TIS) **13 14 50**. It operates 24 hours a day, seven days a week.

## Contact Us

@ [lightrailtowoden@act.gov.au](mailto:lightrailtowoden@act.gov.au)

[act.gov.au/lightrailtowoden](http://act.gov.au/lightrailtowoden)

1800 956 409

Produced by Major Projects Canberra | April 2023